

BU-27135-141

SHT 1.1

NOTES:

LOCATED FROM TWO SURFACES FOR CUSTOMER CONVENIENCE. ONLY APPLICABLE FROM ONE SURFACE, NOT TO BE USED TOGETHER. HORIZONTAL LOCATION FOR TERMINAL CENTERED TO $\pm 0,17$ [.007].

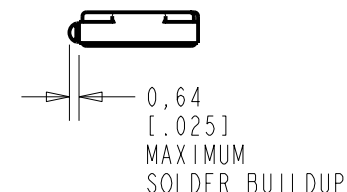
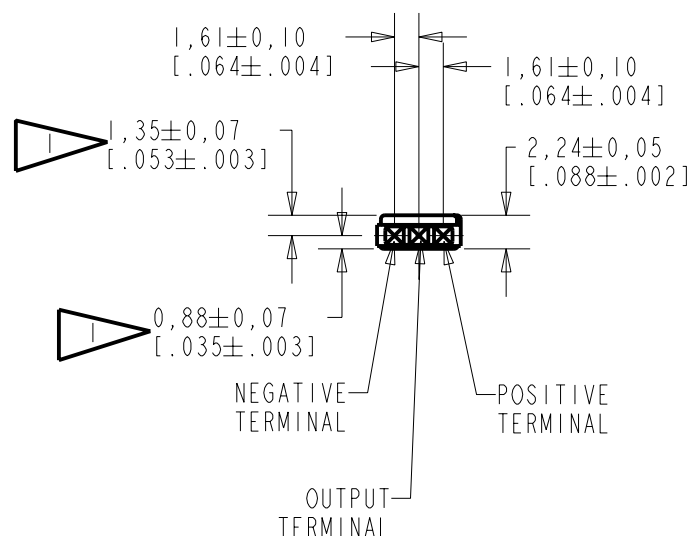
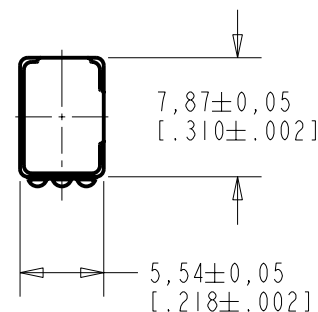

NOMINAL WEIGHT
.28 GRAM

DIMENSIONS IN MILLIMETERS [INCHES]

KNOWLES ELECTRONICS
ITASCA, ILLINOIS U.S.A.

Revision	C.O. #	Implementation Date	RELEASE LEVEL	REVISION
			Released	A
A	C10106341	8-30-07		
SCALE: 2:1			DR. BY	DATE
DO NOT SCALE DRAWING			SJ	8-30-07
			CK. BY	DATE
TITLE: VIBRATION TRANSDUCER			GJP	9-4-07
			APP. BY	DATE
OUTLINE DRAWING			GJP	9-4-07
BU-27135-141			SHT 1.1	

SENSITIVITY IN dB RELATIVE TO 1.0 V/g FOR
CONDITIONS SHOWN BELOW

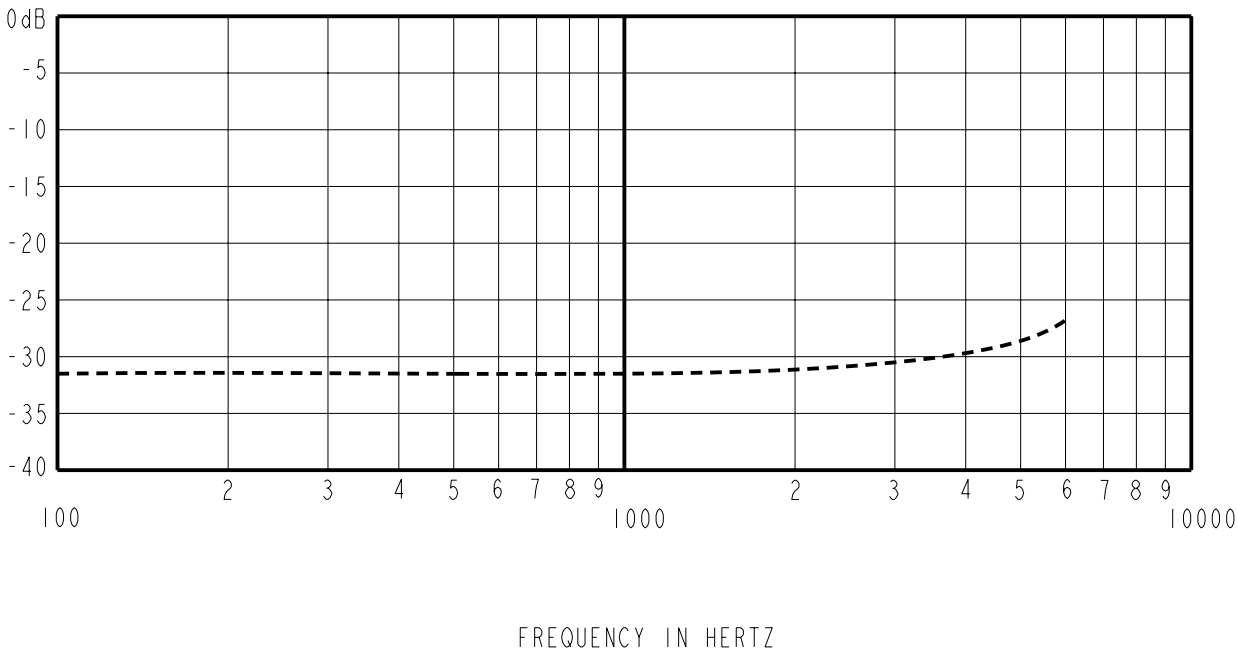

FREQUENCY	SENSITIVITY			DEVICE CONFORMITY	
	MIN.	NOM.	MAX.	RANGE OF DEVIATION FROM 3 kHz	
100	-34.5	-31.5	-28.5	0.0	0.0
1000	-34.5	-31.5	-28.5	0.0	0.0
3000	---	-30.5	---	-3.0	+3.0

NOTES:

1. CASE CONNECTED TO NEGATIVE TERMINAL.

DC SUPPLY	BATTERY CURRENT DRAIN	"A" WEIGHTED NOISE (RE 1.0 V)	OUTPUT IMPEDANCE OHMS (AT 1 kHz)		
			MIN.	NOM.	MAX.
1.5V	50 uA MAX.	-103 dB MAX.	16000	19000	22000

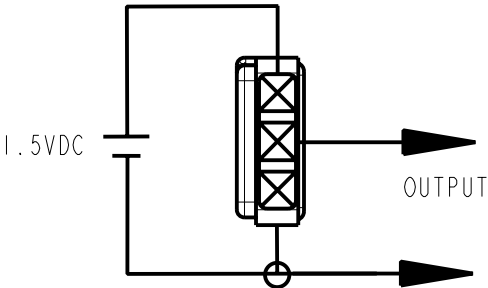

KNOWLES ELECTRONICS
ITASCA, ILLINOIS U.S.A.

Revision	C.O. #	Implementation Date	RELEASE LEVEL	REVISION
			Released	A
A	C10106341	8-30-07		
WHEN TEST LIMITS ARE USED TO ESTABLISH INCOMING INSPECTION ACCEPTANCE/REJECTION CRITERIA, CORRELATION OF TEST EQUIPMENT WITH KNOWLES IS ALSO REQUIRED FOR ELIMINATION OF EQUIPMENT AND TEST METHOD VARIATION			DR. BY	DATE
			SJ	8-30-07
TITLE: VIBRATION TRANSDUCER			CK. BY	DATE
			GJP	9-4-07
PERFORMANCE SPECIFICATION			APP. BY	DATE
			GJP	9-4-07
			BU-27135-141	
			SHT 2.1	