

ED-33465-000

SHT 1.1

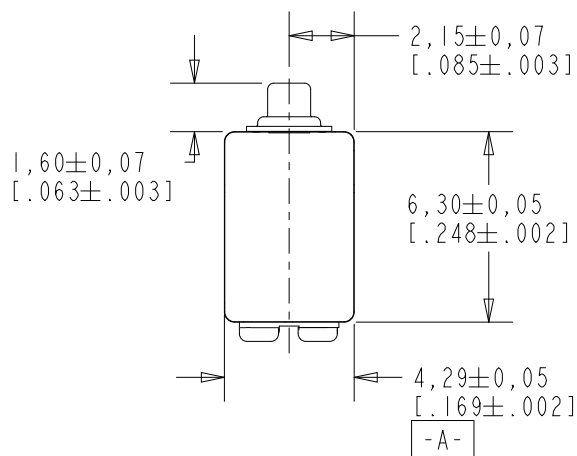

NOTE:

- 1 A POSITIVE GOING VOLTAGE AT TERMINAL 2, RELATIVE TO TERMINAL 1, CAUSES A DECREASE IN PRESSURE AT THE SOUND OUTLET.
- 2 LOCATED FROM TWO SURFACES FOR CUSTOMER CONVENIENCE. ONLY APPLICABLE FROM ONE SURFACE, NOT TO BE USED TOGETHER. HORIZONTAL LOCATION FOR TERMINAL CENTERED TO $\pm 0,17$ [$.007$].
- 3 IT IS IMPORTANT TO KEEP HOLE CLEAN AND CLEAR AT ALL TIMES. CLOGGING THE HOLE WILL CAUSE PERFORMANCE CHANGES.

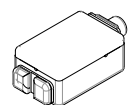
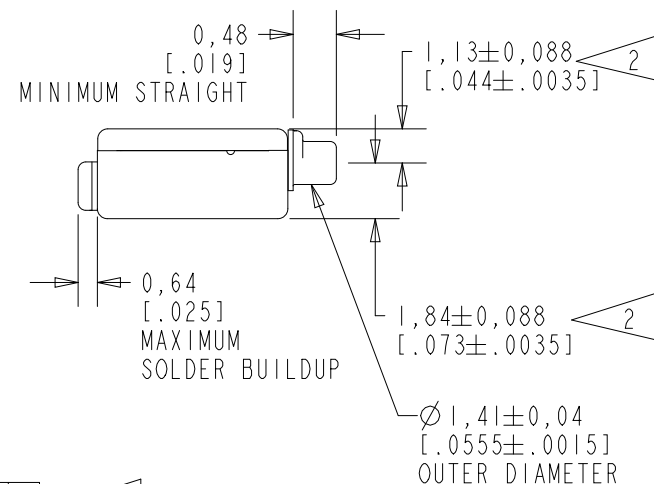
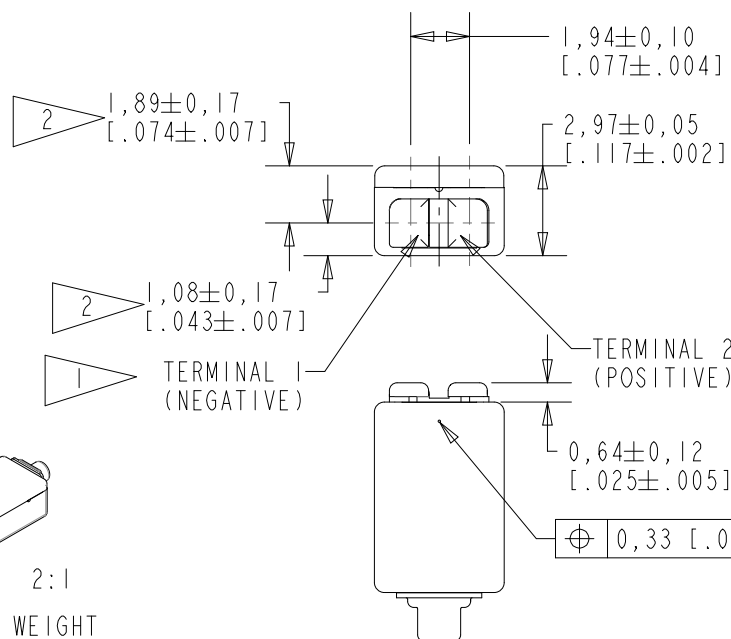

SCALE 2:1

NOMINAL WEIGHT
.31 GRAM

DIMENSIONS IN MILLIMETERS [INCHES]

KNOWLES CORPORATION

Revision	C.O. #	Implementation Date	RELEASE LEVEL	REVISION
			Active	A
A	PI0001950	8-16-18		
SCALE: 4:1			DR. BY DVJ	DATE 9-10-18
DO NOT SCALE DRAWING			CK. BY GJP	DATE 9-12-18
TITLE: RECEIVER		ED-33465-000		APP. BY GJP
OUTLINE DRAWING		SHT 1.1		DATE 9-12-18

NO DAMPING

ED-33465-000
SHEET 2.1

DESCRIPTION

THE ED-33465-000 IS A RESISTIVE VENTED RECEIVER WITH CUSTOMIZED TESTING.

SENSITIVITY IN dB RELATIVE TO 20 uPa FOR
CONDITIONS SHOWN BELOW

FREQUENCY IN HERTZ

ACOUSTICAL

SENSITIVITY*

DEVICE WILL PRODUCE THE SPL LISTED BELOW WUTH THE TEST CONDITIONS DESCRIBED IN TABLES 3. NOMINAL SENSITIVITY AT 1 kHz IS dB RELATIVE TO 20uPa. ALL OTHER VALUES IN dB RELATIVE TO THE SENSITIVITY AT 1 kHz. TEST DATA MEASURED WITH VENT OPEN.

FREQUENCY (Hz)	MINIMUM	NOMINAL	MAXIMUM
200	-4.5	-1.5	+1.5
500	-4.5	-1.5	+1.5
1000	-2.0	108.5	+2.0
2350-3350	+10.0	+13.0	+16.0
5000	-5.0	---	---
6200-7600	+3.0	+6.0	+9.0

TABLE 1.

TOTAL HARMONIC DISTORTION*

DEVICE WILL NOT EXCEED TOTAL HARMONIC DISTORTION LEVELS LISTED BELOW.

FREQUENCY (Hz)	DRIVE (V RMS)	DC BIAS (mA)	LIMIT (%)
500	0.368	0	10
1000	0.130	0	5
1500	0.130	0	5

TABLE 2.

TEST CONDITIONS

NOMINAL SOURCE VOLTAGE	0.130 Vrms, 0 Vdc BIAS
SOURCE IMPEDANCE	< 1 Ω
TUBING	1.76 mm (0.069) LONG, 1 mm (.039) ID.
COUPLER CAVITY	IEC 60318-4 (IEC 711)

TABLE 3.

ELECTRICAL

NOMINAL SOURCE VOLTAGE	0.130 V rms, 0mA DC BIAS
DC RESISTANCE	22.4Ω ±10%
IMPEDANCE @ 500 Hz	22.7Ω ±20%
IMPEDANCE @ 1 kHz	25.7Ω ±20%

ISOLATION: CASE WILL BE ELECTRICALLY ISOLATED FROM THE COIL CIRCUIT

PORT LOCATION: 12C

BUZZ TEST

LISTENING TEST CONDUCTED BETWEEN 50Hz TO 5kHz TO DETECT BUZZ

INPUT VOLTAGE DRIVE SIGNAL	0.130V
----------------------------	--------

TABLE 5.

Revision

C.O. #

Implementation Date

RELEASE LEVEL

REVISION

Active

A

PI0001950

8-16-18

WHEN TEST LIMITS ARE USED TO ESTABLISH INCOMING INSPECTION ACCEPTANCE/REJECTION CRITERIA, CORRELATION OF TEST EQUIPMENT WITH KNOWLES IS ALSO REQUIRED FOR ELIMINATION OF EQUIPMENT AND TEST METHOD VARIATION

DR. BY

DATE

DVJ

9-10-18

CK. BY

DATE

GJP

9-12-18

APP. BY

DATE

GJP

9-12-18

TITLE:

RECEIVER

ED-33465-000

PERFORMANCE SPECIFICATION

SHT 2.1

KNOWLES CORPORATION