

ED-26876-000

SHT 1.1

NOTE:

1 LOCATED FROM TWO SURFACES FOR CUSTOMER CONVENIENCE. ONLY APPLICABLE FROM ONE SURFACE, NOT TO BE USED TOGETHER. HORIZONTAL LOCATION FOR TERMINAL CENTERED TO $\pm 0,17$ [.007].

2 A POSITIVE GOING VOLTAGE AT TERMINAL 2 RELATIVE TO TERMINAL 1, CAUSES A DECREASE IN PRESSURE AT THE SOUND OUTLET.

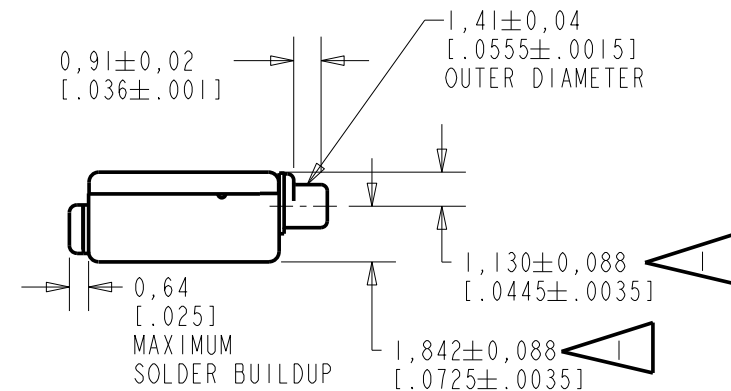
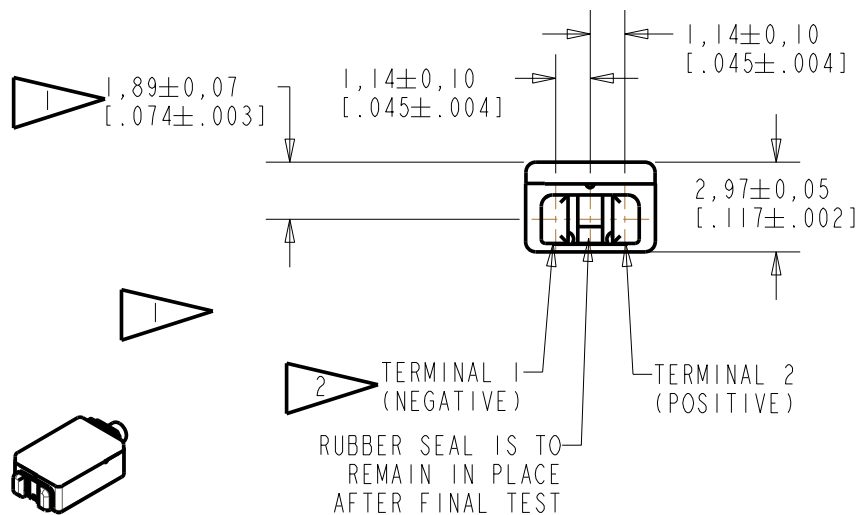
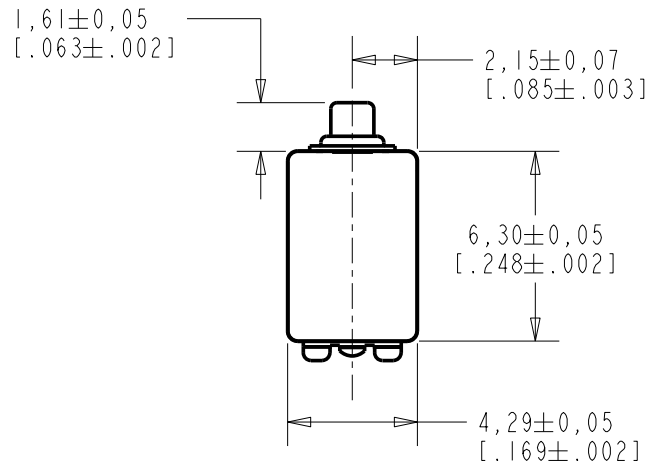

SCALE 2:1

NOMINAL WEIGHT
.31 GRAM

DIMENSIONS IN MILLIMETERS [INCHES]

KNOWLES ELECTRONICS
ITASCA, ILLINOIS U.S.A.

Revision	C.O. #	Implementation Date	RELEASE LEVEL	REVISION
			Active	D
D	CI0107990	8-25-08		

SCALE:

4:1

DO NOT SCALE DRAWING

TITLE:

RECEIVER

OUTLINE DRAWING

ED-26876-000

SHT 1.1

DR. BY	DATE
CRG	12-16-05
CK. BY	DATE
GJP	1-2-06
APP. BY	DATE
GJP	1-2-06

KE111ASIZE.FRM

Rev: B

DESCRIPTION

NO DAMPING

ED-26876-000
SHEET 2.1

A STANDARD ED RECEIVER WITH VOLTAGE DRIVE SPECIFICATIONS AND ROHS COMPLIANCE.
THIS RECEIVER HAS A REAR VENT OPENING ON THE CENTER PAD OF THE TERMINAL.

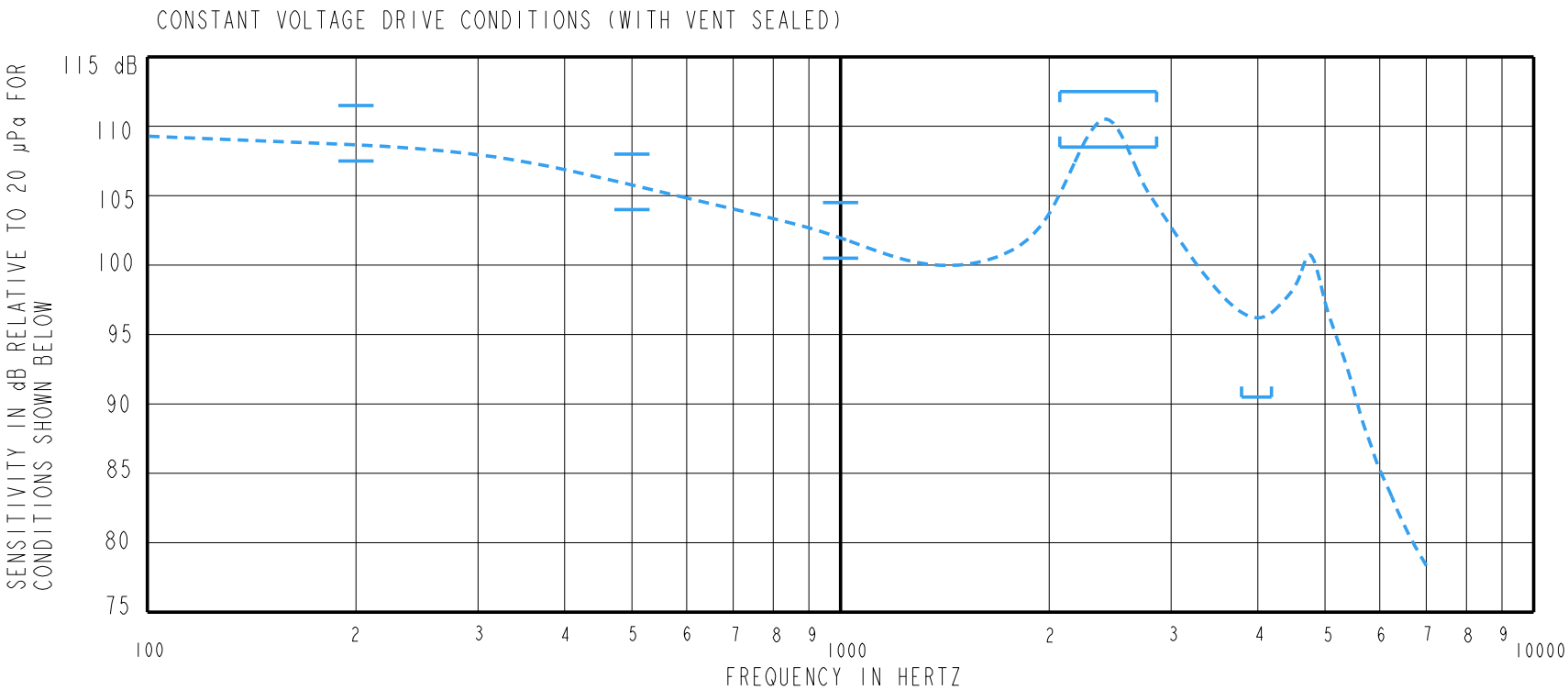

ACOUSTICAL

SENSITIVITY
DEVICE WILL PRODUCE THE SPL LISTED BELOW UNDER TEST CONDITIONS DESRIBED IN TABLE 3.
NOMINAL SENSITIVITY AT 1 kHz IS dB RELATIVE TO 20µPa. ALL OTHER VALUES
IN dB RELATIVE TO THE SENSITIVITY AT 1 kHz. TEST DATA MEASURED WITH VENT SEALED.

FREQUENCY (Hz)	MINIMUM	NOMINAL	MAXIMUM
200	+3.0	+5.0	+7.0
500	+1.5	+3.5	+5.5
1000	-2.0	102.5	+2.0
2000-3000	+6.0	+8.0	+10.0
3700-4400	-12.0	---	---

PORT LOCATION: 12C

TABLE 1.

TOTAL HARMONIC DISTORTION
DEVICE WILL NOT EXCEED TOTAL HARMONIC DISTORTION LEVELS LISTED BELOW.

FREQUENCY (Hz)	DRIVE (V RMS)	DC BIAS (MA)	LIMIT (%)
500	0.413	0	10
780	0.146	0	5
1175	0.146	0	5

TABLE 2.

TEST CONDITIONS

NOMINAL SOURCE VOLTAGE	0.146 Vrms, 0 Vdc BIAS
SOURCE IMPEDANCE	< 1 Ω
TUBING	10 mm (.394) LONG, 1 mm (.039) ID.
COUPLER CAVITY	2 CC SIMULATED ANSI S3.7 TYPE HA-3, (IEC 126)

TABLE 3.

ELECTRICAL

DC RESISTANCE	25 Ω ±10%
IMPEDANCE @ 500 Hz	48 Ω ±15%
IMPEDANCE @ 1 kHz	87 Ω ±15%

TABLE 4.

ISOLATION: CASE WILL BE ELECTRICALLY ISOLATED FROM THE COIL CIRCUIT

KNOWLES ELECTRONICS
ITASCA, ILLINOIS U.S.A.

Revision	C.O. #	Implementation Date	RELEASE LEVEL	REVISION
			Active	D
D	C10107990	8-25-08		
WHEN TEST LIMITS ARE USED TO ESTABLISH INCOMING INSPECTION ACCEPTANCE/REJECTION CRITERIA, CORRELATION OF TEST EQUIPMENT WITH KNOWLES IS ALSO REQUIRED FOR ELIMINATION OF EQUIPMENT AND TEST METHOD VARIATION			DR. BY CRG	DATE 12-16-05
TITLE: RECEIVER PERFORMANCE SPECIFICATION			CK. BY GJP	DATE 1-2-06
			APP. BY	DATE
			GJP	1-2-06

ED-26876-000
SHT 2.1